

# truss

heavy duty truss 30 x 20.5 plated

## heavy duty 30 x 20.5 plated

Standard lengths are 10', 8' and 5'  
Custom lengths available upon request

Equipped with bolts  
Main chords are 2" OD x 1/8" aluminum  
Diagonals are 1" OD x 1/8" aluminum  
Available with casters  
Fabricated by certified welders

Span ft (mtrs)	Maximum allowable uniform loads			Maximum allowable point loads					
	Load lbs/ft	Load lbs (kgs)	Max Defl. in.	center point		third point		quarter point	
				Load lbs (kgs)	Max Defl. in.	Load lbs (kgs)	Max Defl. in.	Load lbs (kgs)	Max Defl. in.
5/8" diameter Grade 8 Bolts with standard washers through 3/8" gusset plates									
10 (3.04)	584	5840 (2649)	0.02	5840 (2649)	0.04	2920 (1325)	0.03	1947 (883)	0.03
20 (6.09)	287	5740 (2604)	0.18	3704 (1680)	0.19	2778 (1260)	0.24	1852 (840)	0.23
30 (9.14)	159	4770 (2164)	0.53	2387 (1083)	0.43	1790 (812)	0.54	1193 (541)	0.51
40 (12.21)	85	3400 (1542)	0.95	1703 (772)	0.78	1277 (579)	0.97	852 (386)	0.90
50 (15.24)	50	2500 (1134)	1.46	1273 (577)	1.23	955 (433)	1.51	637 (289)	1.42
60 (18.28)	32	1920 (871)	2.11	970 (440)	1.80	728 (330)	2.17	485 (220)	2.05

Note: Deflections reported in the above tables are maximum expected for full loadings (indoors only). All loads are based on 10'(3.04 m) sections. Load tables are reprinted from engineering reports developed by Parkhill, Smith & Cooper, Inc., structural engineers, and apply to truss fabricated after December, 1989.

# truss

heavy duty truss 30 x 20.5 plated

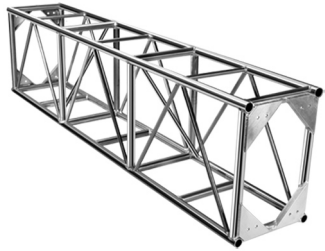

heavy duty truss 30 x 20.5 plated  
End plates equipped for double sets of bolts, supplied with one set only

Product Description	Item Code	Weight lbs (kgs)	Product Description	Item Code	Weight lbs (kgs)
5-FT HEAVY DUTY TRUSS	Bolt TRS 3020-060B	63 (28)	HD ARTICULATING BLOCK VERTICAL (center pivot)	Bolt TRS 3020-AVB	67 (31)
8-FT HEAVY DUTY TRUSS	Bolt TRS 3020-096B	86 (39)	HD VARIABLE CORNER HORIZ. (book style with brace)	Bolt TRS 3020-VHB	55 (25)
10-FT HEAVY DUTY TRUSS	Bolt TRS 3020-120B	94 (43)	HD VARIABLE CORNER VERT. (book style with brace)	Bolt TRS 3020-VVB	50 (23)
HEAVY DUTY 2-WAY CORNER	Bolt TRS 3020-C2B	35 (16)	HD 2-WAY SLEEVE BLOCK FOR 12" TOWER	Bolt TRS 3020-S2B	46 (21)
HEAVY DUTY 3-WAY CORNER	Bolt TRS 3020-C3B	42 (19)	HD 3-WAY SLEEVE BLOCK FOR 12" TOWER	Bolt TRS 3020-S3B	53 (24)
HEAVY DUTY 4-WAY CORNER	Bolt TRS 3020-C4B	47 (21)	HD 4-WAY SLEEVE BLOCK FOR 12" TOWER	Bolt TRS 3020-S4B	59 (27)
HD ARTICULATING BLOCK HORIZONTAL (center pivot)	Bolt TRS 3020-AHB	67 (31)			

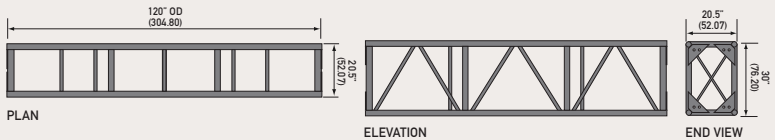

PLAN VIEWS

